

## *Modular Thread Mills*

- Modular thread mill heads with carbide adapters for long reach thread milling.
- Multiple flutes design for high performance thread milling.
- Available in thread sizes from M12 to M24, with effective cutting depths from 100mm to 200mm



Modular Thread Mills Index

Type Number		Pitch		No. of Threads	P	M	K	N	S	H	Page
ETMWM		TP	0.5 ~ 3	4 ~ 16	●	●	●	○	●	●	02
ETMWU		TPI	32 ~ 8	5 ~ 9	●	●	●	○	●	●	02

Appearance	Name	Code No.	Overall Length	Shank Dia.	Page
	Carbide Adapter (Straight) 鎢鋼抗震刀桿 (直柄型)	SWMEA	100 ~ 200	10 ~ 14	03
	Carbide Adapter (Straight Neck) 鎢鋼抗震刀桿 (直頸型)	SWMEB	100 ~ 200	10 ~ 16	03

Cutting Method

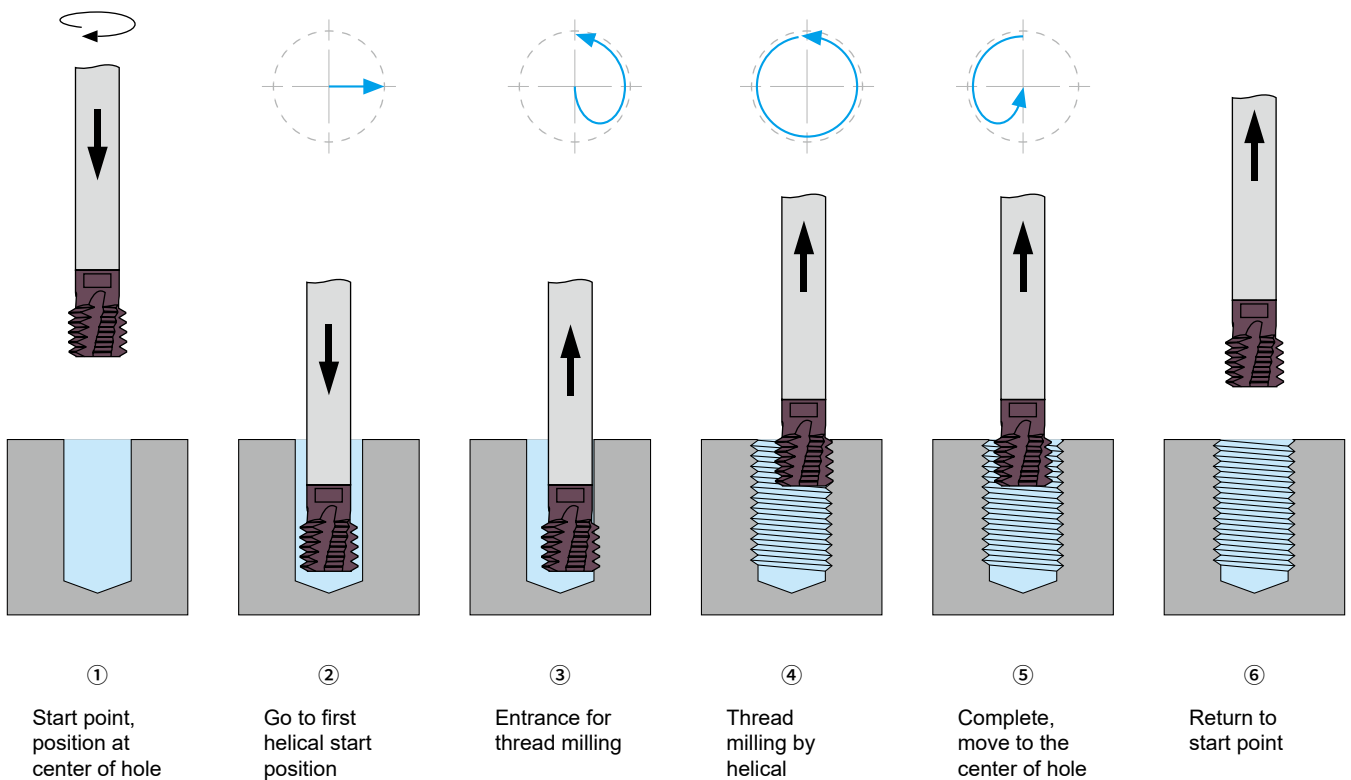

S910 Modular Threading Head

ETMWM (ISO M)

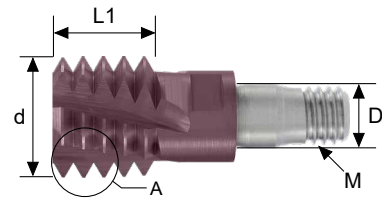
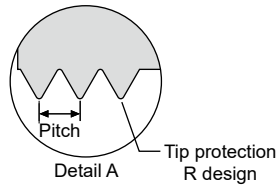

Order No.	Thread Size	Dia. (d)	Pitch	CL (L1)	No. of Threads	ND (D)	M (M)	Flutes (Z)	Adapter Dia. (d2)	Wrench
ETMWM41000050U	≥ M14 * 0.5	10	0.5	8	16	6.5	M6	4	8.5	ISP0809
ETMWM41000075U	≥ M12 * 0.75	10	0.75	6.75	9	6.5	M6	4	8.5	ISP0809
ETMWM41000100U	≥ M12 * 1	10	1	7	7	6.5	M6	4	8.5	ISP0809
ETMWM51200100U	≥ M16 * 1	12	1	9	9	6.5	M6	5	10	ISP1011
ETMWM41200125U	≥ M16 * 1.25	12	1.25	8.75	7	6.5	M6	4	10	ISP0809
ETMWM41200150U	≥ M16 * 1.5	12	1.5	9	6	6.5	M6	4	10	ISP0809
ETMWM61600150U	≥ M20 * 1.5	16	1.5	13.5	9	8.5	M8	6	14	ISP1213
ETMWM51600200U	≥ M19 * 2	16	2	14	7	8.5	M8	5	13	ISP1011
ETMWM51540250U	≥ M20 * 2.5	15.4	2.5	15	6	8.5	M8	5	12	ISP1011
ETMWM31600300U	≥ M24 * 3	20	3	15	5	10.5	M10	4	15.5	ISP1213

ETMWU (UN)

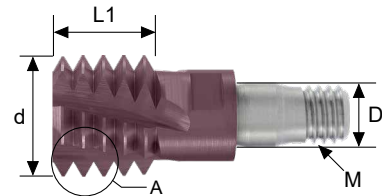
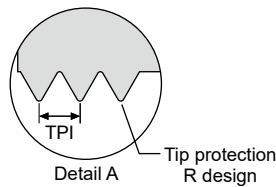

Order No.	Thread Size			Dia. (d)	TPI	CL (L1)	No. of Threads	ND (D)	M (M)	Flutes (Z)	Adapter Dia. (d2)	Wrench
	UNC	UNF	UNEF									
ETMWU41000032U	-	-	-	10	32	7.1	9	6.5	M6	4	8.5	ISP0809
ETMWU41000028U	-	1/2"	-	10	28	6.3	7	6.5	M6	4	8.5	ISP0809
ETMWU41000024U	-	-	9/16"-5/8"	10	24	6.3	6	6.5	M6	4	8.5	ISP0809
ETMWU41200024U	-	-	5/8"-11/16"	12	24	7.4	7	6.5	M6	4	10	ISP0809
ETMWU41200020U	-	-	3/4" - 1"	12	20	8.9	7	6.5	M6	4	10	ISP0809
ETMWU41200018U	-	5/8"	≥ 1 11/16"	12	18	8.5	6	6.5	M6	4	10	ISP0809
ETMWU41200016U	-	3/4"	-	12	16	9.5	6	6.5	M6	4	8.5	ISP0809
ETMWU41200014U	-	7/8"	-	12	14	9.1	5	6.5	M6	4	8.5	ISP0809
ETMWU51600014U	-	7/8"	-	16	14	14.5	8	8.5	M8	5	13	ISP1011
ETMWU51600012U	-	1"-1 1/2"	-	16	12	12.7	6	8.5	M8	5	13	ISP1011
ETMWU41530010U	3/4"	-	-	15.4	10	15.2	6	8.5	M8	4	12	ISP1011
ETMWU41600009U	7/8"	-	-	16	9	14.1	5	8.5	M8	3	12	ISP1011
ETMWU41600008U	1"	-	-	20	8	15.9	5	10.5	M10	4	15.5	ISP1213

Carbide Adapter - ISO M Threads

**SWMEA**

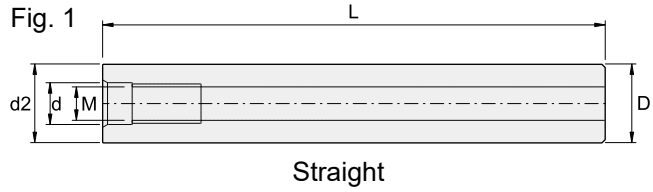

**SWMEB**

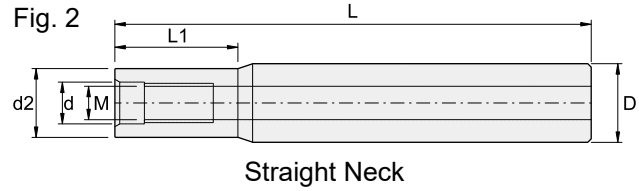

OrderNo.	Dimensions(mm)						Fig.
	d2	d	L1	L	D	M	
ISWMEB10100060	8.5	6.5	24	100	10	M6	2
ISWMEA10100060	10	6.5	-	100	10	M6	1
ISWMEA10150060	10	6.5	-	150	10	M6	1
ISWMEA12100080	12	8.5	-	100	12	M8	1
ISWMEA12150080	12	8.5	-	150	12	M8	1
ISWMEA12200080	12	8.5	-	200	12	M8	1
ISWMEB14100080	13	8.5	30	100	14	M8	2
ISWMEB14150080	13	8.5	60	150	14	M8	2
ISWMEB14200080	13	8.5	100	200	14	M8	2
ISWMEB16150082	13	8.5	32	150	16	M8	2
ISWMEA14100080	14	8.5	-	100	14	M8	1
ISWMEA14150080	14	8.5	-	150	14	M8	1
ISWMEA14200080	14	8.5	-	200	14	M8	1
ISWMEB16150083	14	8.5	80	150	16	M8	2
ISWMEB16100101	15.5	10.5	50	100	16	M10	2

Customize available.

**Wrench Specifications**

Order No.
ISP0809
ISP1011
ISP1213

